

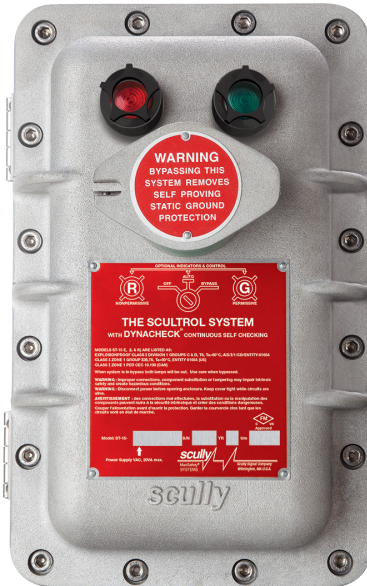

ST-15

Single Point Overfill Prevention Controller

Featuring Dynacheck® – Automatic and Continuous Self-Checking Circuitry



ST-15



DESCRIPTION

The Scully single point overfill prevention controllers feature two-wire optic or thermistor sensing. They are mounted at a loading rack or fill station for connection to a single compartment tank vehicle.

For additional static bond/ground proving options, the system works in conjunction with the Scully ST-47 Groundhog Self-Proving Grounding Verification System.

FEATURES AND BENEFITS

- Maximum safety with Dynacheck® automatic and continuous self-checking circuitry.
- Will not permit loading under any fault or wet sensor conditions.
- Signals for automatic shut-off of product flow within a half-second of detecting an overfill condition.
- Ideal overfill prevention for refuelers, rail tank cars, tank trucks, chemical trailers and other one compartment vehicles.
- 30 years of proven, dependable performance.
- Easy connection to vehicles with versatile high impact plug and cable units.
- Approved by Factory Mutual (FM).

Technical Diagram of Model ST-15 ELK
All Dimensions in Inches (Millimeters in Parenthesis)

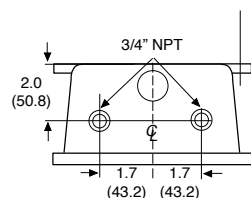

Top View

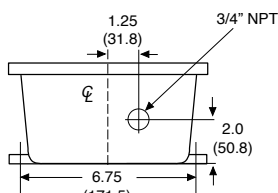

Bottom View

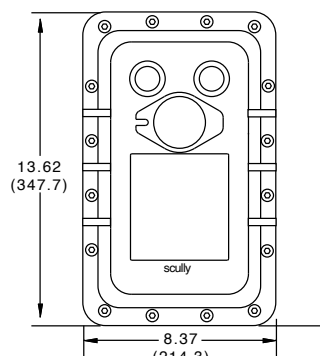

Front View

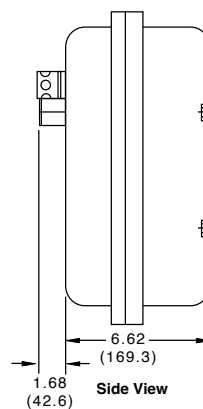

Side View

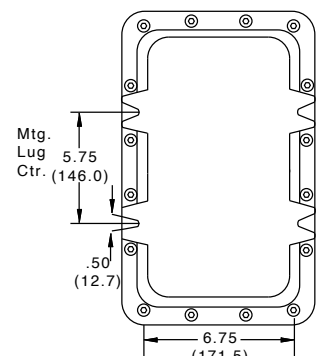

Back View



Single Point Overfill Prevention Controller

TECHNICAL SPECIFICATIONS

FM & CSA Approved

Versions of:

Thermistor Sensors SP-BL, SP-BLU, SP-BLH.
Two-wire Optic Sensors SP-TO, SP-IO, SP-IR,
SP-TO(SS), SP-TO(SS)HP.

Enclosures: Explosion-proof, weathertight. Corrosion
inhibiting epoxy paint optional.

Indicator Lamps: Red = Power On/Non-Permit.
Green = Permit.

Approvals: Explosion-proof with intrinsically safe sensor
connection outputs. Rated for Class I, Division 1,
Groups C & D Hazardous Locations, by FM Global (FM) to
Canadian and United States standards.

Turn on response time:
6 – 30 seconds (typical) for thermistors. Two-wire optics turn
on instantly.

Shutdown Response Time: Less than 1 second.

Power Requirements:

ST-15-115 Models: 105–130 VAC, 50/60 Hz.
20 Watts maximum.
ST-15-240 Models: 210–250 VAC, 50/60 Hz.
20 Watts maximum.

Connections: Provided by internal terminal strips.

Output Control: One normally open volt free contact,
rated 250 VAC, 5A resistive.

Output Control Fuse: Internal 5A.

Weight: 28 lbs. (12.7 kg).

NOTE: The Scully ST-15 is an intrinsically safe system. For maximum safety,
it should be used only in conjunction with sensors manufactured by Scully
not to jeopardize the conditions of the approvals.

SIL Capable



ORDERING INFORMATION

CONTROL UNITS

Model	Description	Part Number
ST-15-115-EL	Single Point Controller with Explosion-proof Housing and Indicator Lamps, 115VAC	07528
ST-15-115-ELK	Single Point Controller with Explosion-proof Housing, Indicator Lamps, Lockable Bypass Switch, 115VAC	07677
ST-15-240-EL	Single Point Controller with Explosion-proof Housing and Indicator Lamps, 240VAC	07640
ST-15-240-ELK	Single Point Controller with Explosion-proof Housing, Indicator Lamps, Lockable Bypass Switch, 240VAC	07547

SYSTEM ACCESSORIES

SC-8B Sculcon Junction Box, 10 Contacts/ 4 J Slots Green Plug, 30' Orange Coiled Cable	08677
SC-6A Sculcon Junction Box, 8 Contacts/ 2 J Slots Green Plug, 20' Orange Straight Cable	07582
SC-6A Sculcon Junction Box, 8 Contacts/ 2 J Slots Green Plug, 30' Orange Coiled Cable	08156
10 Contact, 4 J-Slot Pull-Away Plug (SC-8B) with 30' Coiled Cable	36159
13 Position, Pullaway Socket	09569

REPLACEMENT PARTS

Module Assembly	ST-15C-120 Single Point Controller	08756
Module Assembly	ST-15C-240 Single Point Controller	08656

Copyright © 2025 Scully Signal Company. Dynacheck, Dynamic Self-Checking, Dynamic Self-Test, Faylsafe, IntelliCheck, Intellitrol,
Intelliview, Load Anywhere, Maxsafety, Sculcon, and V.I.P. are registered trademarks of Scully Signal Company. All Rights Reserved.
Specifications are subject to change without notice.

01-2
January 2025



Scully Signal Company
800 272 8559
sales@scully.com
Wilmington, MA, USA

Scully Systems Europe NV
+32 (0) 15 56 00 70
sales@scully.be
Mechelen, Belgium

Scully UK Ltd
+44 (0) 1606 553805
sales@scullyuk.com
Winsford Cheshire, UK

Scully Systems India
+91 9821799566
salesindia@scully.com
Maharashtra, India

